

# FOR LEASE

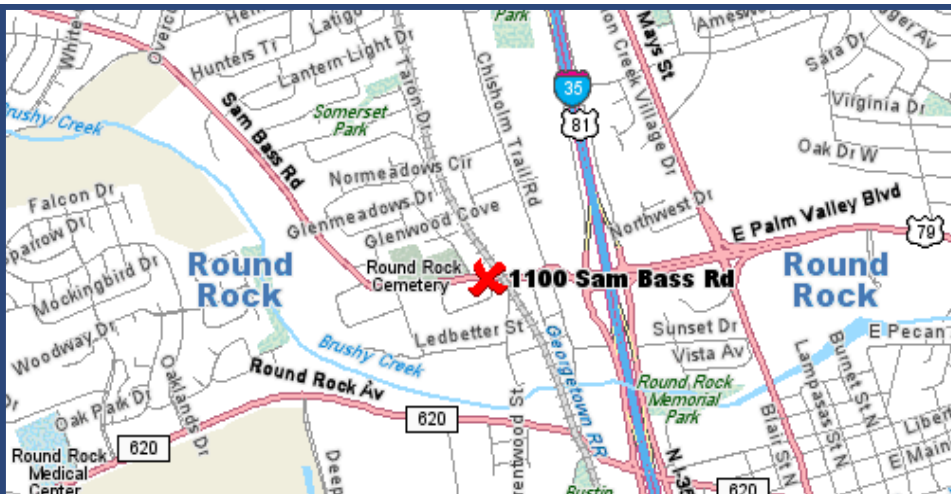

# Sam Bass Market Center

1100 Sam Bass Road  
Round Rock | Texas | 78681

- Located on Sam Bass Rd. 1/3 mile west of IH-35, past the railroad tracks.
- Spaces range in size from 1,330 SF - 4,500 SF.
  - Building 1: 4,500 SF retail shell space available (3 suites).
  - Building 2: 6,000 SF retail/office/flex space available (4 suites).
  - Building 3: 3,105 SF retail/office/flex space available (2 suites).
  - Building 4: 1,480 SF retail/office/flex space available (1 suite).
- Year Built: 2008
- Specific uses for these spaces include retail sales, community services, restaurants, coffee shop, office, medical office, etc.
- Zoning: C-2 (local commercial).

**DON  
QUICK**  
& associates, inc.

Contact  
Darren Quick, Realtor®  
Charles Harvey, Realtor®  
512.255.3000  
Info@donquik.com

1000 N. IH-35, Suite A | Round Rock | TX | 78681

Phone 512.255.3000

www.DonQuick.com

The material contained in this memorandum is based in part upon information furnished to Don Quick & Associates, Inc. by sources deemed to be reliable. The information is believed to be accurate in all material respects, but no representation or warranty, expressed or implied, as to list accuracy or completeness is made by any party. Nothing contained herein should be relied upon as a promise or representation as to the future. Recipients should conduct their own investigation and analysis of the information described herein.

# Exhibit "B"

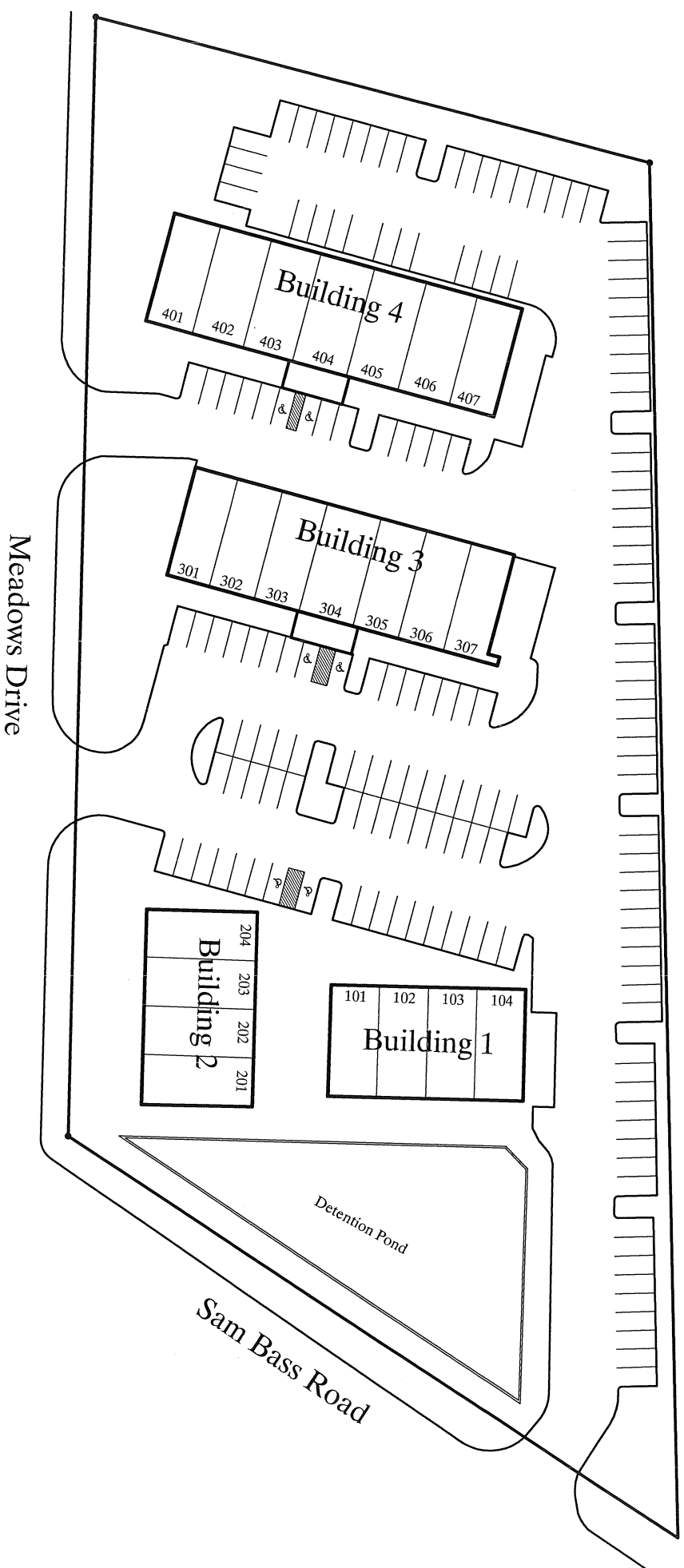

## Building and Parking Layout

no scale

note: this layout is subject to change without notice. Drives and parking spaces are approximates only.

Sam Bass Market Center  
1100 Sam Bass Road  
Round Rock, TX

# Sam Bass Market Center

## Available Lease Spaces

<b>Bldg I</b>	<u>Suite</u>	<u>Rentable SF</u>	<u>Rent (Annual)</u>	<u>Contiguous Spaces Available</u>	<u>Total Building Space Available</u>
	101	1500	\$ 24 PSF	3000 SF (Sts. 103&104)	4500 SF
	103	1500	\$ 24 PSF		
	104	1500	\$ 24 PSF		
<b>Bldg II</b>	<u>Suite</u>	<u>Rentable SF</u>	<u>Rent (Annual)</u>	<u>Contiguous Spaces Available</u>	<u>Total Building Space Available</u>
	201	1500	\$ 18 PSF	3000 SF (Sts. 201&202)	6000 SF
	202	1500	\$ 18 PSF	3000 SF (Sts. 202&203)	
	203	1500	\$ 18 PSF	4500 SF (Sts. 201,202&203)	
	204	1500	\$ 18 PSF	4500 SF (Sts. 202,203&204)	
<b>Bldg III</b>	<u>Suite</u>	<u>Rentable SF</u>	<u>Rent (Annual)</u>	<u>Contiguous Spaces Available</u>	<u>Total Building Space Available</u>
	304	1775	\$ 18 PSF	3105 SF (Sts. 304&305)	3105 SF
	305	1330	\$ 18 PSF		
<b>Bldg IV</b>	<u>Suite</u>	<u>Rentable SF</u>	<u>Rent (Annual)</u>	<u>Contiguous Spaces Available</u>	<u>Total Building Space Available</u>
	402	1480	\$16 PSF	1480 SF (Ste. 402)	1480 SF