

FOR LEASE



13611 Immanuel Road Pflugerville | Texas | 78660

- Located in Dessau Business Park, approximately 2.5 miles east of IH-35 near the intersection of Howard Lane and Dessau Rd. in Pflugerville.
- 10,153 SF office / warehouse building.
- Approximately 1,825 SF of office space.
- Four 14' x 12' grade level doors.
- Fenced yard in the rear of the building.
- Zoning: None (Austin ETJ).
- Rate: \$.65 PSF (\$7.80 PSF annual) NNN.

**DON
QUICK**
& associates, inc.

Contact
Brent Campbell, Realtor®
512.255.3000
Brent@donquick.com

1000 N. IH-35, Suite A | Round Rock | TX | 78681
Phone 512.255.3000 **www.DonQuick.com**

The material contained in this memorandum is based in part upon information furnished to Don Quick & Associates, Inc. by sources deemed to be reliable. The information is believed to be accurate in all material respects, but no representation or warranty, expressed or implied, as to list accuracy or completeness is made by any party. Nothing contained herein should be relied upon as a promise or representation as to the future. Recipients should conduct their own investigation and analysis of the information described herein.

13611 Immanuel Road

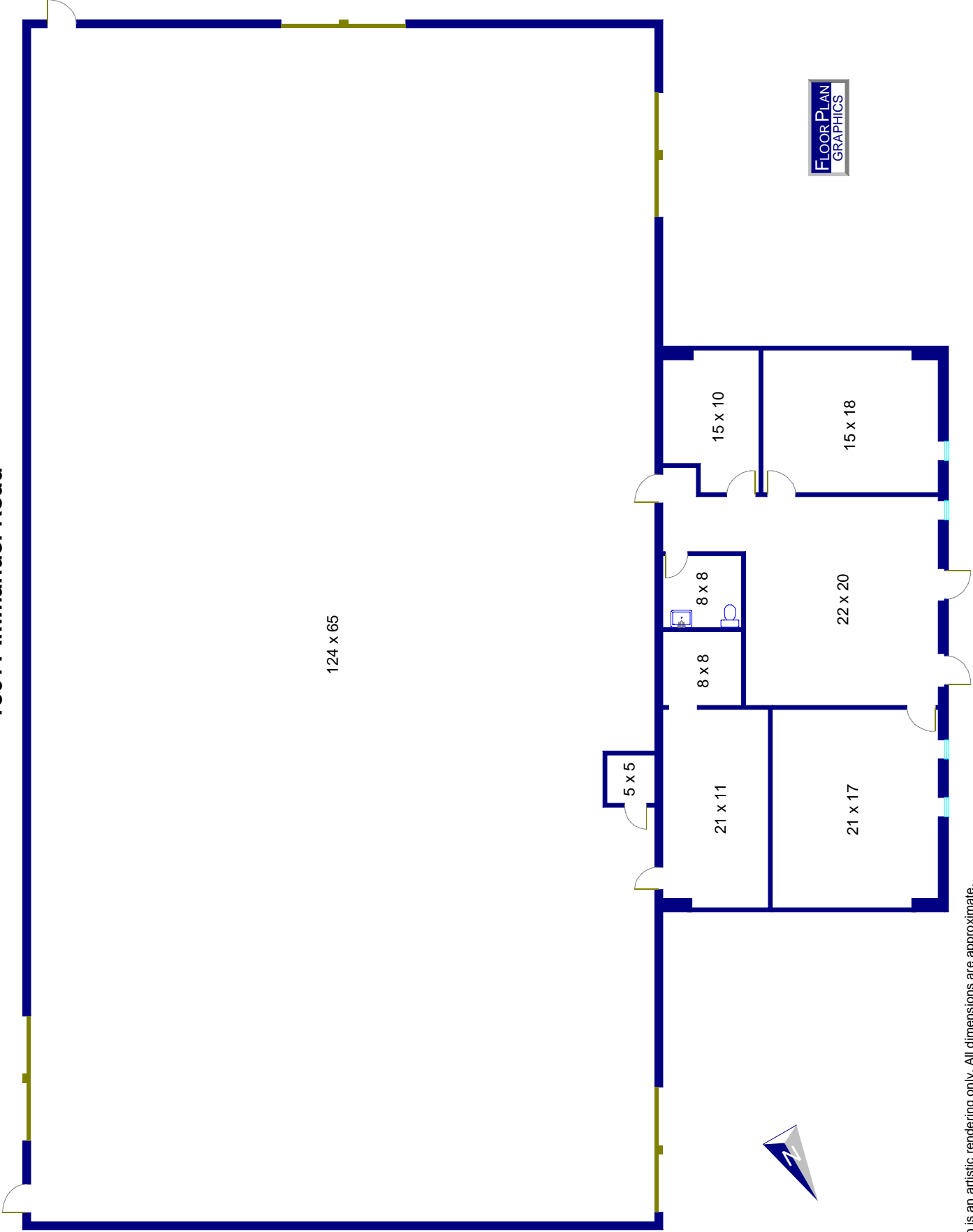

124 x 65



FLOOR PLAN
GRAPHICS

Note: This floor plan is an artistic rendering only. All dimensions are approximate. Floor Plan Graphics makes no representation or warranty as to this rendering's accuracy and no measurements or dimensions should be relied upon without independent verification.