

# FOR LEASE

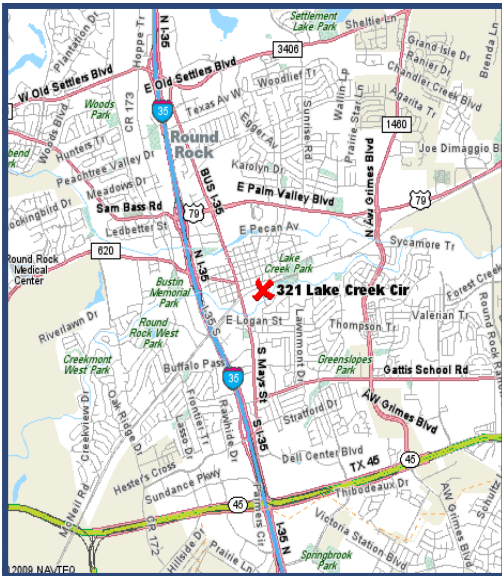

## 321 N. Lake Creek Drive Round Rock | Texas | 78681

- Located directly across from Round Rock High School, just south of RR 620.
- 5,600 SF, one story professional office building.
- Space Available: Approximately 2,068 SF.
- Perfect for Medical, Dental, or Attorney's office.
- The space is currently a shell space, the slab will be poured when the plumbing is planned.
- \$15.00 PSF TI.
- This space is the front end-cap, nearest to Lake Creek Drive.
- Plenty of parking with at least 1:250.
- Rate: \$15.00 PSF + NNN.



Contact  
**Darren Quick, Realtor®**  
**512.255.3000**  
**Darren@donquick.com**

**1000 N. IH-35, Suite A | Round Rock | TX | 78681**  
**Phone 512.255.3000**      **www.DonQuick.com**

The material contained in this memorandum is based in part upon information furnished to Don Quick & Associates, Inc. by sources deemed to be reliable. The information is believed to be accurate in all material respects, but no representation or warranty, expressed or implied, as to list accuracy or completeness is made by any party. Nothing contained herein should be relied upon as a promise or representation as to the future. Recipients should conduct their own investigation and analysis of the information described herein.

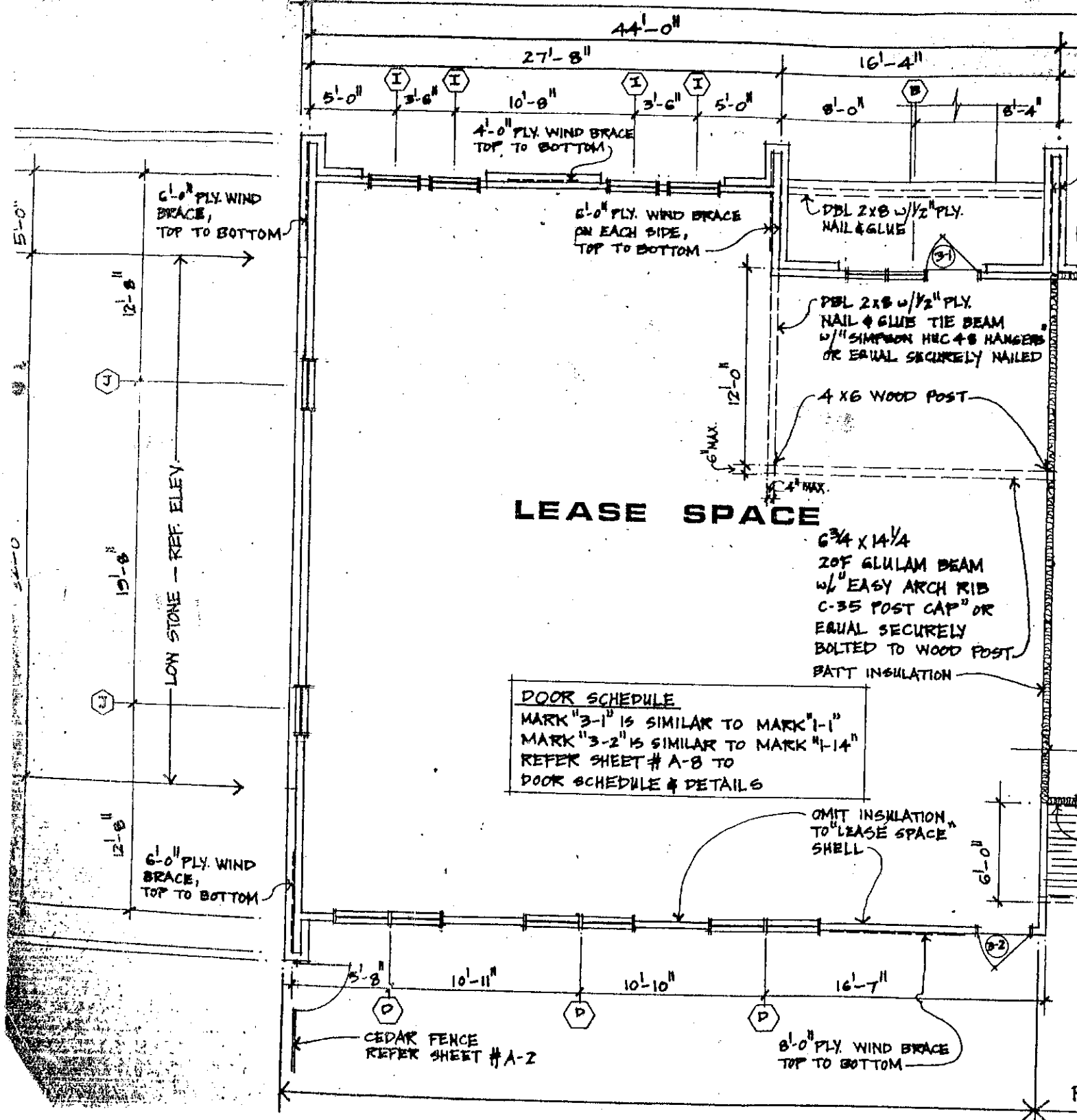

**LEASE SPACE**

6<sup>3</sup>/<sub>4</sub> X 14<sup>1</sup>/<sub>4</sub>  
 20' GLULAM BEAM  
 w/ 1" EASY ARCH RIB  
 C-35 POST CAP" OR  
 EQUAL SECURELY  
 BOLTED TO WOOD POST.  
 BATT INSULATION

DOOR SCHEDULE  
 MARK "3-1" IS SIMILAR TO MARK "1-1"  
 MARK "3-2" IS SIMILAR TO MARK "1-14"  
 REFER SHEET # A-8 TO  
 DOOR SCHEDULE & DETAILS

OMIT INSULATION  
 TO "LEASE SPACE"  
 SHELL

CEDAR FENCE  
 REFER SHEET # A-2

8'-0" PLY. WIND BRACE  
 TOP TO BOTTOM

6'-0" PLY. WIND BRACE,  
 TOP TO BOTTOM

6'-0" PLY. WIND BRACE  
 ON EACH SIDE,  
 TOP TO BOTTOM

4'-0" PLY. WIND BRACE  
 TOP TO BOTTOM

6'-0" PLY. WIND BRACE,  
 TOP TO BOTTOM

LOW STONE - REF. ELEV.

5'-0"

12'-8"

15'-8"

12'-8"

12'-8"

44'-0"

27'-8"

16'-4"

5'-0"

3'-6"

10'-8"

3'-6"

5'-0"

8'-0"

8'-4"

12'-0"

6" MAX.

4" MAX.

10'-9"

16'-7"

5'-8"

10'-11"

10'-10"

I

I

I

I

D

D

D

B

4

2

31

32